

### Construction

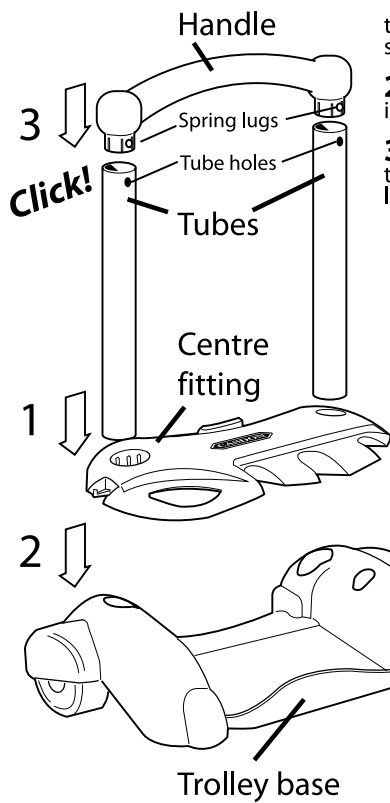

1. Feed the 2 large tubes with the ends without the tube holes into the 'Centre fitting' moulding so that it sits approx. 100mm from the tube holes.
2. Push the base portion of the tubes into 2 large socket holes of the 'Trolley Base'.
3. Push the 'Handle' into the tubes and twist the tubes to align the spring lugs into the tube location holes. You hear a 'click!' when it is secured.

4. Twist and secure the 'Long tube handle' into the 'broom head' as shown. Locate the 'end cap' onto the opposite end of the 'long tube handle' and twist to secure. Ensure that all twist fittings are fully tightened.
5. Push the 'middle length tube' through the top hole of the 'mop cowling'; then push the 'ball joint spigot' through the lower hole of the mop cowling and twist to secure fully onto the 'middle length tube'. Next twist and secure the 'tube connector' onto the opposite end of the 'middle length tube'. Locate the 'short tube handle' to the opposite end of the 'tube connector' twist to secure and tighten. Locate the 'end cap' onto the opposite end of the 'short tube handle' and twist to secure. Finally push and clip the 'ball joint' into the hole at the top of the 'mop base' until you hear a Click!

(Ensure that all twist fittings are fully tightened)

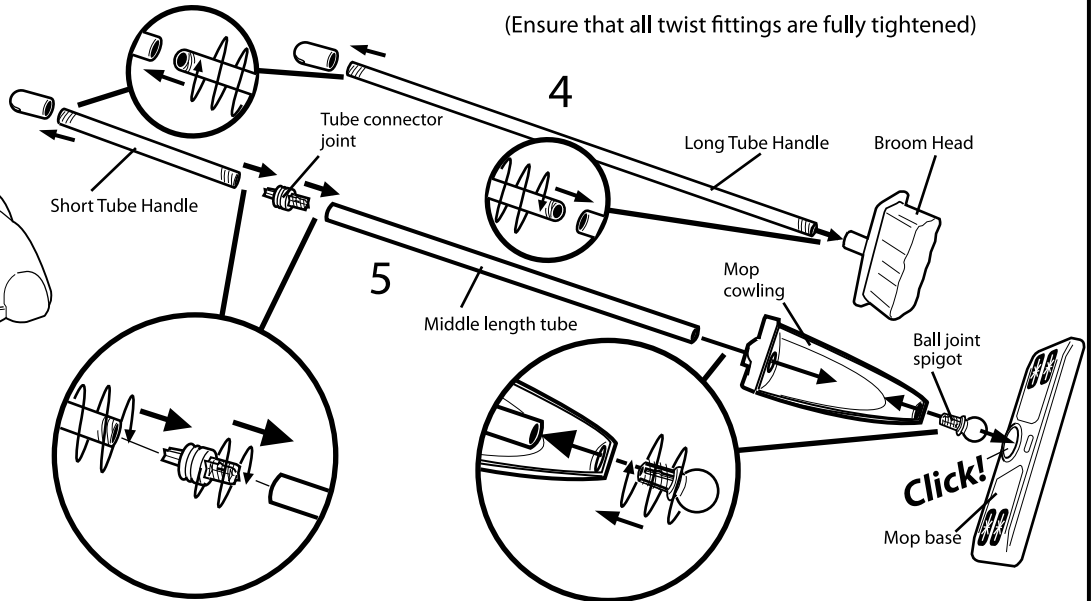

### Location for stickers and accessories:

(Apply stickers as shown)

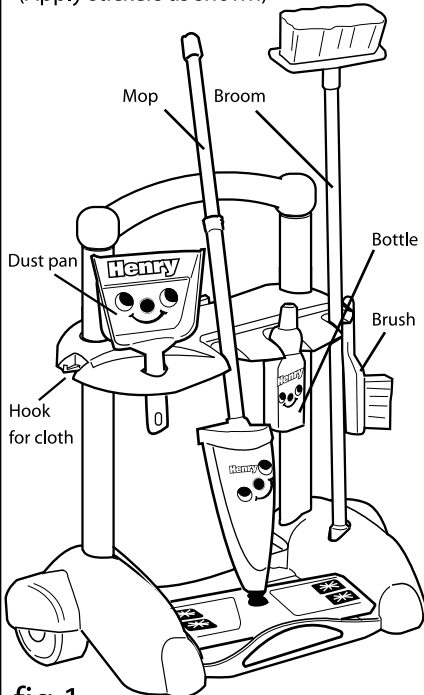

### Methods of hanging the paper bag:

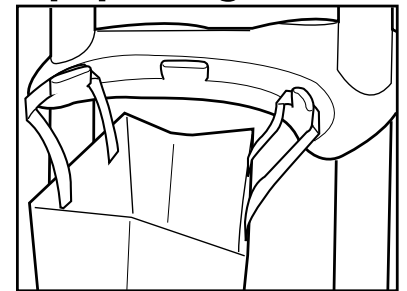
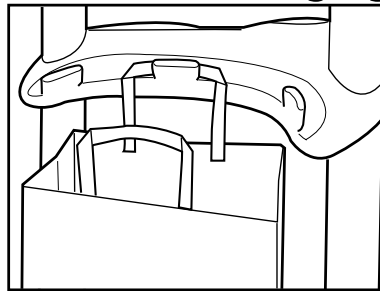

### Attaching cloth to mop base:

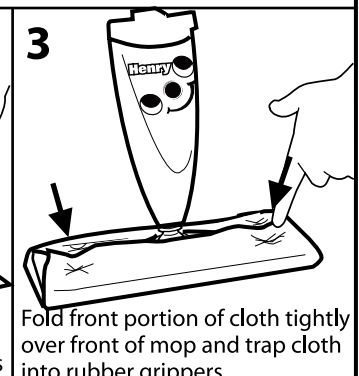
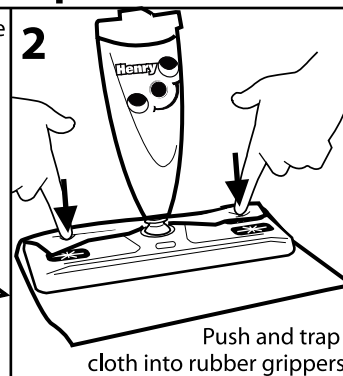
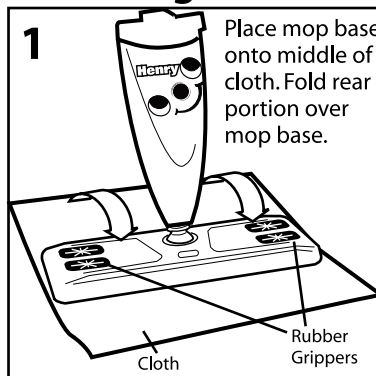

**WARNING:**  
**CHOKING HAZARD** - Small parts.  
Not suitable for children under 3 years.

Adult supervision is recommended with all children.

